

Stub Tube Connector

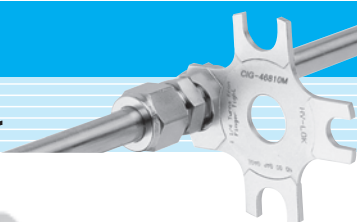

Installation Instruction Port Connectors

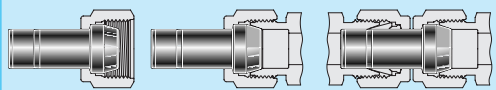

Fig.1 Fig.2 (1/4 turn) Fig.3 (1 1/4 turn)

Machined Ferrule End

While holding fitting body steady, tighten the port connector one-quarter turn from the finger-tight position. For 1/16", 1/8", and 3/16", ; 2mm 3mm and 4mm tube fittings, tighten the port connector one-eighth turn. For over 1in. and over 25mm tube fittings, tighten the port connector one quarter turn.

Reassembly

You may disassemble and reassemble Hy-Lok port connectors many times. Make subsequent connections by slightly tightening with a wrench after snugging the nut by hand.

Tube adapter End

- 1.Insert the tube adapter into the Hy-Lok two ferrule tube fittings until tubing end is firmly seated on the body shoulder and make sure the nut is hand tight.(Fig.3)
- 2.Mark the nut at 9 o'clock position for identification of starting point.
- 3.Tighten the nut 1 1/4turns* with a wrench keeping the fitting body steady with a back-up wrench, when the nut is tightened 1 1/4 turns, the mark at 9o'clock position before tightening will be at 12o'clock position.

Note* : Only 3/4 turn from finger tight is required for 1/16",1/8",3/16"2mm,3mm,and 4mm sizes.

Reassembly

See Hy-Lok two ferrule tube fittings reassembly, page71

Port Connector CPC

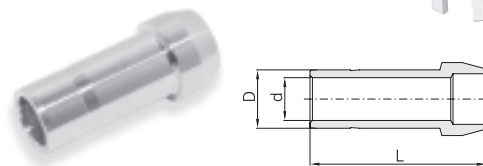

Connects Two Fractional Hy-Lok Ports

| Part No. | Tube O.D. D | | d Min. | L |
|----------|----------------|-------|-----------|-------|
| | in | mm | | |
| CPC - 1 | 1/16 | 1,58 | 0,76 | 13,72 |
| CPC - 2 | 1/8 | 3,17 | 2,03 | 22,35 |
| CPC - 4 | 1/4 | 6,35 | 4,32 | 24,89 |
| CPC - 5 | 5/16 | 7,93 | 5,59 | 25,91 |
| CPC - 6 | 3/8 | 9,52 | 6,86 | 26,67 |
| CPC - 8 | 1/2 | 12,70 | 9,40 | 36,32 |
| CPC - 12 | 3/4 | 19,05 | 14,73 | 37,85 |
| CPC - 16 | 1 | 25,40 | 20,32 | 49,28 |

Connects Two Metric Hy-Lok Ports

| Part No. | Tube O.D. D | d Min. | L |
|-----------|----------------|-----------|-------|
| CPC - 3M | 3 | 1,9 | 22,20 |
| CPC - 4M | 4 | 2,2 | 23,21 |
| CPC - 6M | 6 | 4,1 | 25,00 |
| CPC - 8M | 8 | 5,6 | 26,00 |
| CPC - 10M | 10 | 7,1 | 27,10 |
| CPC - 12M | 12 | 8,8 | 36,20 |
| CPC - 15M | 15 | 11,2 | 37,80 |
| CPC - 16M | 16 | 12,0 | 37,80 |
| CPC - 18M | 18 | 13,9 | 37,80 |
| CPC - 20M | 20 | 15,5 | 39,40 |
| CPC - 22M | 22 | 16,1 | 38,97 |
| CPC - 25M | 25 | 19,9 | 49,30 |
| CPC - 28M | 28 | 22,5 | 63,50 |
| CPC - 32M | 32 | 26,5 | 69,70 |
| CPC - 38M | 38 | 31,6 | 81,90 |

Reducing Port Connector CPR

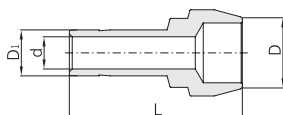

Connects Two Fractional Hy-Lok Ports

| Part No. | Tube O.D. D | | Reduced O.D. D ₁ | | d Min. | L |
|-------------|----------------|-------|--------------------------------|-------|-----------|-------|
| | in | mm | in | mm | | |
| CPR 2 - 1 | 1/8 | 3,17 | 1/16 | 1,58 | 0,76 | 18,30 |
| CPR 4 - 1 | 1/4 | 6,35 | 1/16 | 1,58 | 0,76 | 19,05 |
| CPR 4 - 2 | 1/4 | 6,35 | 1/8 | 3,17 | 2,03 | 22,86 |
| CPR 6 - 2 | 3/8 | 9,52 | 1/8 | 3,17 | 2,03 | 23,37 |
| CPR 6 - 4 | 3/8 | 9,52 | 1/4 | 6,35 | 4,32 | 25,40 |
| CPR 8 - 4 | 1/2 | 12,70 | 1/4 | 6,35 | 4,32 | 29,72 |
| CPR 8 - 6 | 1/2 | 12,70 | 3/8 | 9,52 | 6,86 | 30,73 |
| CPR 12 - 8 | 3/4 | 19,05 | 1/2 | 12,70 | 9,40 | 37,85 |
| CPR 16 - 8 | 1 | 25,40 | 1/2 | 12,70 | 9,40 | 42,93 |
| CPR 16 - 12 | 1 | 25,40 | 3/4 | 19,05 | 14,73 | 43,69 |

Connects Two Metric Hy-Lok Ports

| Part No. | Tube O.D. D | Reduced O.D. D ₁ | d Min. | L |
|---------------|----------------|--------------------------------|-----------|-------|
| CPR 6M - 3M | 6 | 3 | 1,9 | 22,90 |
| CPR 8M - 6M | 8 | 6 | 4,1 | 25,40 |
| CPR 10M - 6M | 10 | 6 | 4,1 | 25,80 |
| CPR 10M - 8M | 10 | 8 | 5,6 | 26,30 |
| CPR 12M - 6M | 12 | 6 | 4,1 | 29,60 |
| CPR 12M - 8M | 12 | 8 | 5,6 | 30,10 |
| CPR 12M - 10M | 12 | 10 | 7,1 | 30,60 |
| CPR 16M - 6M | 16 | 6 | 4,1 | 29,37 |
| CPR 16M - 12M | 16 | 12 | 8,8 | 37,50 |
| CPR 28M - 25M | 28 | 25 | 19,9 | 56,50 |
| CPR 32M - 25M | 32 | 25 | 19,9 | 60,30 |
| CPR 38M - 25M | 38 | 25 | 19,9 | 65,80 |

All dimensions are in millimeters unless otherwise specified. Dimensions are for reference only, subject to change.